

EVERGREEN CEMETERY

SELF-GUIDED TOUR & MAP

1137 North Broad Street, Hillside, NJ 07205 (908) 352-7940



The people who are buried in Evergreen Cemetery reflect the history of the community since 1853, when the cemetery was founded by clergymen and businessmen from Elizabethtown and Newark. They believed that a non-profit non-denominational cemetery was necessary because the church graveyards in Elizabethtown and Newark were filled and too small. In addition, at least two Elizabethtown churches. Second Presbyterian Church and St. John's Episcopal Church wanted to enlarge their buildings.

The 30 acre John Teas Farm on the Upper road in Union township was selected. By 1928 the cemetery covered 115 acres in Hillside, Elizabeth and Newark.

The administration building started out as a barn. Before it was completed in 1912, the board of trustees of the cemetery decided a new office was needed and the changes were made. The original mausoleum row is opposite the office. Among the buildings is the cemetery's

mausoleum where cremated remains may be interred. The Rankin Mausoleum, the first on the left, has the Egyptian over the door and the heavy pillars found on many early Egyptian buildings.

The cemetery has many impressive funerary monuments. Doric and Ionic pillars frequently support tiny roofs for structures that are modeled after ancient temples or palaces

Symbolism is everywhere, Columns and urns adorned with drapes mean mourning. If a column looks as though it has been sawed off and also is draped, it means that life was cut short. The urns mean ashes of death. A grapevine carved on a monument means that the vine is the church and the branches are its members. The heart is a symbol of the soul. Flowers reflect the life of man (or woman) beauty and the brevity of life, the crown represents the victorious soul, trees mean both earthly and heavenly life, the willow indicates both joy and loss of life.

The monuments range from the simple upright sandstone of the colonial period to monoliths. Footstones to ledger stones, to sculptured and garden type memorials of granite. A few monuments are metal, slate, marble, brownstone and boulders. Statues adorn some graves. One, made in Italy, is for a Helen Wagner who died in 1912 and lived across from the cemetery. There are two reclining ladies, several men pointing to the bleeding heart, others of Mary and Christ. There is a replica of Rodin's "Winged Victory", as well as a small nymph, a tiny lion, several lambs and angels.

There are a variety of crosses such as the Gothic and Wayside crosses on an ornate octagonal shaft supporting a small cross with a gable hood. The simple or true crosses, the Celtic cross featuring a circle and cross and the Greek cross with two cross bars. The Star of David is on many stones. A few feature the Muslim crescent and others show fraternal or patriotic symbols.

The short walk (about an hour in length) will take you to the graves of writers. Congressional Medal of Honor recipients and community leaders. It is limited to the oldest or Victorian section of the cemetery featuring winding roads, circular graves and an ancient copper beech tree.

1. We will begin with the
2. Mary
3. William Fayal Clarke, a friend of Mrs. Dodge's sons, joined her at "St. Nicholas Magazine" and later became the editor too. He is buried at her feet. He also wrote short stories and poetry.
4. Walk east, toward Newark, to the grave of Chancellor William Jay Magie, the son of Rev. Dr. David Magie, founder and first minister of the Second Presbyterian Church in Elizabeth, and a founder of the cemetery. Ivy and other plants are in front of the monument. Under the 1776 Constitution, the governor of New Jersey served as the top Judge of the state. The second Constitution, adopted in 1844, established the position of chancellor for the top judge. William Jay Magie was appointed as the

second chancellor. Read his tombstone. It outlines his legal career.

5. Look to the left. Do you see a large monument surrounded by a series of smaller monuments with a circle around it? This is the largest and one of the oldest plots in the cemetery. It belongs to the Chetwood Family. Among them are William Chetwood, who served with the troops in Pennsylvania in the Whiskey Rebellion. John Chetwood, a Congressman from California, and Francis B. Chetwood, who served as mayor before Elizabeth became a city and then for two more terms after it was incorporated.

There are many graves in Section C of 19th Century Elizabeth people. Near the road are...

6. William Bloomfield Sayre, a 16 year old youth, whose burial in 1854, was the first in the cemetery. The writing on the marker has disappeared because of acid rain.
7. A short distance away from him in a pathway is the grave of 18 year old Private Robert D. Talley, United States Army, who was killed Feb. 27, 1991 in the Persian Gulf War. This is a United States Government Marker and is flush with the ground.

Look across the road. You will see a fenced plot. During the 19th Century iron fences surrounded many of the plots. Most of these have been removed to make it easier to mow the lawns. Two of the gates to these plots remain.

8. Look to the right for the Clark monument. Behind it are four small matching markers for the Chidsey Family. The marker at the right contains names of four members of the Donald Barr Chidsey family. Donald Barr Chidsey grew up in Elizabeth, attended Pingry School and Princeton University, and was one of the writers for Edward Stratemeyer. He had a career as an author of non-fiction historical books for adolescents.
9. About five rows from the Chetwood monument to the East are two tall monuments. The first is for Rev. Dr. David Magie, who is mentioned above. His monument was donated by his congregation and the name of the monument works is on it. Very few monument manufacturers signed their monuments.
10. The adjacent monument is for Joseph Cross, MD, an area doctor for many years. Cross Avenue in Elizabeth is named for him.
11. A rectangular shaped box-like structure nearby is for Samuel Wilder for whom nearby Wilder Street on the Elizabeth-Hillside line is named.
12. North of the Magie monument is the colonial style marker of Elias Darby, last mayor of Elizabethtown Borough and first mayor of Elizabeth City.
13. A small green plaque on a nearby stone just Northeast of the Chetwood plot is for Daniel H. Sayre, Union township Clerk and member of the Board of Health.
14. Walk back along the road. You will see an American flag, two canon and rows of stones. This is the Civil War Veterans' Section. When the Civil War broke out, the trustees of the cemetery allotted land for free burials for veterans. Study the stones. You will discover that members of the Colored Troops, as the African-Americans were called, are buried among the whites. The last Civil War veteran was buried in 1945. Can you find his marker? The canon are from the Spanish-American war. The

cemetery also set aside land for the Elizabeth Orphanage and the Home for Aged Women in Section B.

15. At the end of Section C, opposite the Veterans' Section is a mound. This is one of the first mausoleums. Unlike the others, it extends eight feet below ground! It was built for Dr. John Washington, who practiced medicine in New York City. He objected to paying taxes so he built a building in Elizabethport and called it a church. The city however thought otherwise and he was forced to pay.
16. Walk pass the mound. Near the corner on the right is the grave of Peter Engenolf for whom the Egenolf Day Nursery in Elizabeth is named. Egenolf was an officer at the Prudential Insurance Company in Newark and as he and his wife had no children, they left their estate to the Elizabeth Day Nursery. The nursery continues to receive money from the Egenolf estate to this day.
17. Walk about 50 feet along the road. Watch for a broken, white monument. Behind it you will find the government marker for General J. Madison Drake, a veteran of the Civil War, and author of at least two books and owner of several newspapers in Elizabeth. Drake is one of three Medal of Honor recipients in the cemetery. As a founder and member of the Veteran Zouaves, he participated in many patriotic events throughout the nation.
18. The cemetery contains the graves of several members of the House of Representatives. Amos Clark, Jr., an attorney, is a short distance from Drake. He also was a member of the City Council and the State Senate. He was a party in one of Elizabeth's most famous law suits. When the grade crossing and the Union Railroad Station were eliminated and the Arch was built, it left the front door to Clark's property eight feet in the air.
19. William Corbin, another attorney, who represented the Central Railroad in the suit, is buried opposite him. He also served as an Assemblyman and member of the Elizabeth Board of Education. He is the author of *Corbin's Forms*.
20. Rev. Dr. Jonathan Magie, the first president of Centenary College when it was a technical school was a clergyman as well as an educator.
21. David Naar was the first Jewish mayor of Elizabeth, the first Jewish member of the Essex County Board of Chosen Freeholders and state treasurer. He subsequently served as consul to the Island of St. Thomas and was editor and publisher of *The True*

American, a Trenton newspaper which opposed the Civil War.

22. Just beyond the Naar grave are two large plots. One for the Ward Family contains the grave of Dr. Isaac Moreau Ward, a medical doctor, who had a farm in the present Weequahic Park opposite Lyons Avenue, Newark. William Ward, his son, was an agriculturist and founder of the New Jersey Agricultural Society. His grandson, Dr. William R. Ward Sr., was the horse and buggy doctor in Lyons Farm (Newark and Hillside), president of the New Jersey Sons of the American Revolution and the New Jersey Historical Society.

23. In the Kellogg Plot is Edward Kellogg, who purchased many farms in Elizabeth and subdivided them as the Industrial City of Elizabeth. Kellogg Park in Elizabeth is named for the family. James Kellogg, chairman of the New York and New Jersey Port Authority, is one of the family members buried there. The graves are shaded by a Copper Beech Tree that is nearly 400 years old. It is one of two ancient trees on the cemetery property. The other is a WHITE OAK (see Map for Area K).

MAP OF EVERGREEN CEMETERY

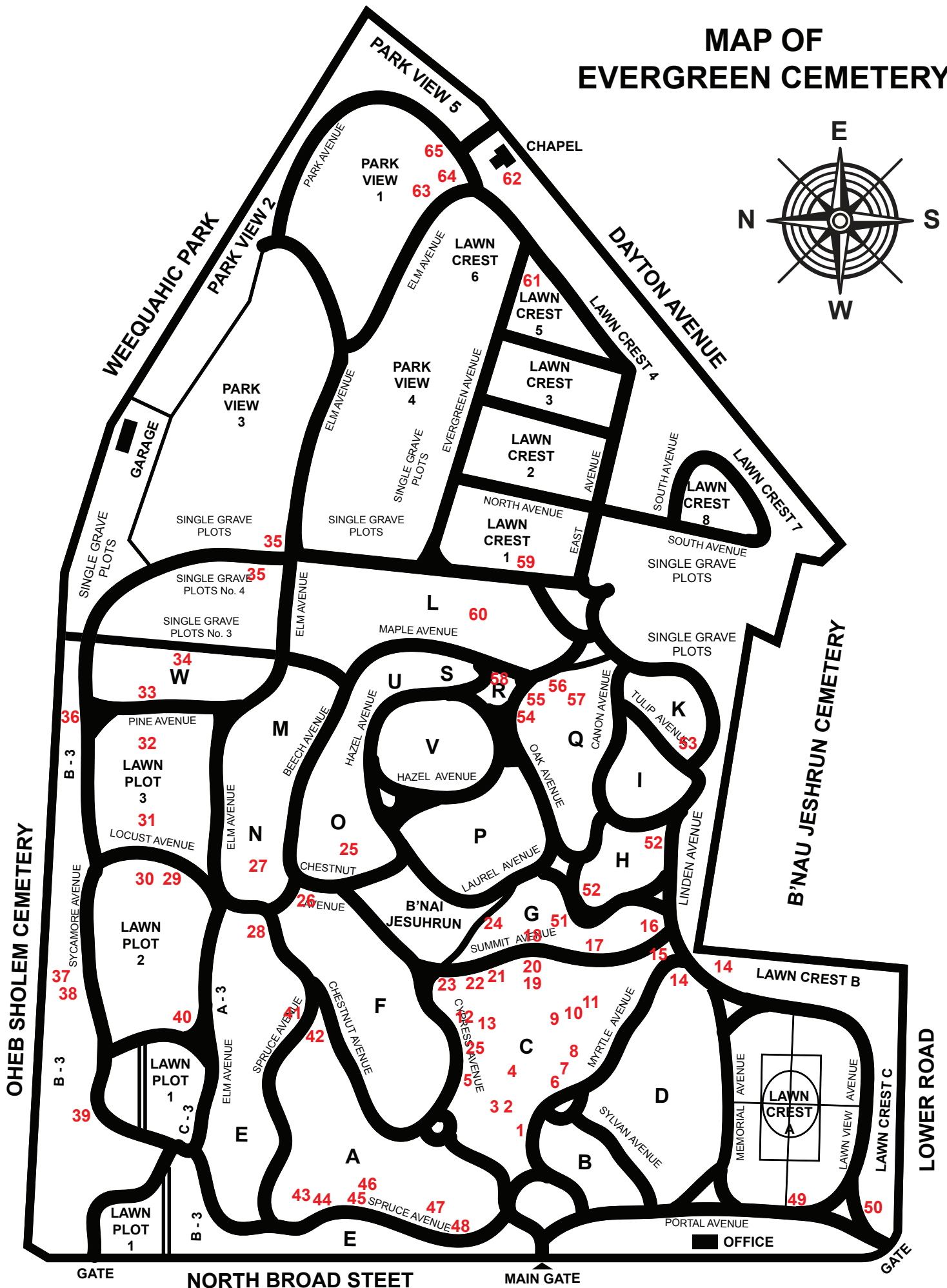
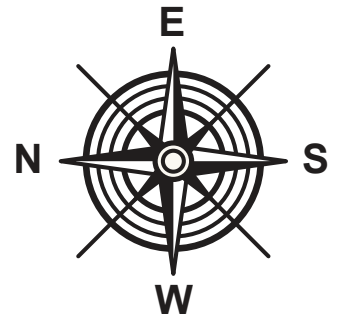

1. Crane
2. Dodge
3. Clarke
4. Magie
5. Chetwood
6. Sayre
7. Talley
8. Chidsey
9. Magie
10. Cross
11. Wilder
12. Darby
13. Sayre
14. Civil War Veterans
15. Washington
16. Egenolf
17. Drake
18. Clark
19. Corbin
20. Meeker
21. Naar
22. Ward
23. Kellogg
24. Mendelsohn Benevolent Society B'Nai Jeshurun
25. Jouet, Grant, Baxter, Hughes
26. Collingwood
27. Baptist Home Crittendon Home
28. Keat
29. Faulks
30. Diehl
31. King
32. Allen
33. March
34. Rupp
35. Children's Section
36. Wiegand
37. Home for Aged Women
38. Elizabeth Orphanage
39. Tomlinson
40. Kean
41. Stratemeyer

42. Jones
43. Cotton, Smith,, Alward
44. Brandt
45. Rankin
46. Martin
47. Sulzer
48. Dimock
49. Wagner
50. Stevens
51. Van Buskirk/Jaques
52. Richards, Mack
53. White Oak Tree
54. Williamson
55. Brisbin
56. Ryder
57. Chinese Pilots
58. Masons
59. Dmystriv
60. Franklin Street Methodist Church
61. Gypsies
62. Chapel
63. Myshuha
64. Mary
65. Lee

24. Opposite the Naar grave near the Amos Clark Jr. monument are the areas sold to MENDELSON BENEVOLENT SOCIETY in 1854 and CONGREGATION B'NAI JESHURUN a short time later. (There are two markers for the society. Can you find them?) B'Nai Jeshurun in 1906, purchased additional land and has a cemetery adjacent to Evergreen on the east. Congregation Oheb Shalom also purchased land to the west of the cemetery in 1900 for a cemetery there. The Evergreen board of trustees subsequently stopped selling land to private groups, but however, it did agree to make some areas available. When St. John's Ukrainian Church in Newark sought a site, the trustees agreed to make land available in Park View 4 near Dayton Street.

25. Perhaps you have noticed that the plots vary in shape and form and the paths and roadways are curved. This is typical of the Victorian design of the 19th Century. The 20th Century plots are rectangular in shape. At the intersection of Sections G, F and O you can see a replica of the "Winged Victory" without one wing. Near the roadway are

two monuments for the Jouet family. Their ancestor, Cavalier Jouet, was a Tory and fled to England during the Revolutionary War. The Jouets buried here were born in Canada, but moved to Roselle when adults. There also is a stone for Orvil Grant, a brother of President General Ulysses S. Grant, who came by ferry with a team of horses for a graveside service. (The monument faces the “Winged Victory”. (One side is covered by a tree.) Section O also contains the grave of James Baxter, the first colored principal of the colored school in Newark. The city’s board of education invited him to come to the city after the Civil War and open the school. He did and operated the school until 1909, when he retired and subsequently died. He is noted for demanding excellence from his pupils and many of them, including his daughter (who became a teacher), became professionals. The school, adjacent to the House of Prayer in Newark, is used by the Newark Board of Education today. Near his grave is one for Jennie Van Name Hughes, a missionary to China.

26. From the intersection of Sections G, F and O, walk between F and O. Just before the next street look for the Bonnett lot. In the front row there is the grave of Francis Collingwood, Jr., a civil engineer, who assisted Washington Roebling in the building of the Brooklyn Bridge. Mayor Peter Bonnett of Elizabeth, later the city comptroller, also is in the plot.
27. Section N contains a plot owned by the Baptist Home, while Section M has a plot for the Florence Crittendon Home For Unwed Mothers, both in Newark. Neither is marked.
28. Continue along the hill to Section E. A short way down the street note the Keat grave on the right. This is a plot provided for the Second Presbyterian Church and St. John’s Episcopal Church, both in Elizabeth, when graves were moved from the church graveyards to the cemetery to make room for building. Few of the markers were moved.
29. Return to the corner. Walk between Section N and E to the next roadway. Turn right and then left. You should be between Lawn Plots 2 and 3. Notice the Faulks footstones. Look for the marker for Theodosia Garrison Faulks, a poet, whose work appeared in women’s magazines between 1900 and 1940.
30. Take the path to the left just beyond the Faulks plot. Look for the Diehl monument on the right. Philip Diehl was an inventor who initially worked for the Singer Manufacturing Company and later established his own company manufacturing electrical parts.

31. Walk down the central path in Lawn Plot 3 to the grave on the right of Rufus King, a career United States Army veteran who was also awarded the Congressional Medal of Honor. He resided on North Avenue where the East Campus of Kean University is. King has a government grave marker.
32. Continue along the pathway. Beyond a small circle is the grave of Rev. Dr. Lyman Whitney Allen, pastor of the defunct Second Presbyterian Church in Newark and author of patriotic poems.
33. If you continue toward the hill you will come to Section W where two drowning victims are buried. The first is John Starr March, one of five postmen on the HMS Titanic, whose body was the 225th to be pulled out of the Atlantic Ocean. He has the family monument and a stone like the ones on victims graves in cemeteries in Halifax, Nova Scotia, where many of the unclaimed bodies were buried. (His monument is two rows from the leaning statue along the road for the White Family and the third plot from the road.)
34. William C. Rupp was a Westinghouse employee on the excursion boat, Eastman, when it capsized at Chicago during a company outing in 1915. He is in a single grave facing the road between Section W and the Children's Section. His marker is two rows from the White monument on the opposite side from the Titanic and second row from the road.
35. The Children's Section is composed of small single graves. There were many deaths of children before inoculations were mandatory. Can you find two similar white crosses? They are for twins who died several months apart. Several have small lambs or angels on the top of the monuments. There are single graves for adults at the bottom of the hill in Section L to the right and across road in Park View 1 and Lawn Crest 1.
36. Walk toward B-3 between Section W and Lawn Plot 3. The Weequahic Park Golf Course and Oheb Shalom Cemetery are ahead of you. You are at the boundary line between Essex and Union Counties. Turn to the left. On the right watch for the monument of George Wiegand, a composer and musician, who played with the New York Philharmonic.
37. When you reach Lawn Plot 2 watch for a group of tiny stones together. This is the plot for the Home for Aged Women.
38. A short distance away, also on the right, is the Elizabeth Orphanage plot. All graves are for boys.

39. Continue to B-3. Watch for the Tomlinson plot. The first small stone at the left is for Rev. Everett Tomlinson, pastor of the Central Baptist Church in Elizabeth who left the ministry to devote his time to writing books for boys.
40. Turn around and take the road between Lawn Plots 1 and 2. At the end of the road turn left. The Kean plot with its flat Tiffany stones is there. State Senator John Kean, a great-uncle of Governor Thomas Kean, and six members of the Kean Family are buried here.
41. Leaving the Kean plot walk directly over Section E toward F. When you reach the roadway between Sections F, A, and E, turn right. Look for a monument that has carvings of books and bookends at the top. This is the Stratemeyer stone. Edward Stratemeyer, 1862-1930, introduced the continuing series of books for boys and girls where the same characters appeared in many books. The books were written according to a formula that he gave each writer. Donald Barr Chidsey was one of them. The series included "Nancy Drew", "The Rover Boys", "Tom Swift", "The Hardy Boys", "The Bobbsey Twins" and many others.
42. Continue down the road between the Sections A and E. Note the grave of Phineas Jones on the right in a raised plot surrounded by a small concrete wall. Jones was a circus wagon wheel manufacturer and the company was located at various times in Newark, Elizabeth and finally Hillside. It went out of business when circuses started moving in trucks.
43. Walk between Sections E and A to the next road. Shortly after the turn are the Cotton and Brant plots. A cluster of three rows of monuments set sideways to the road is the family plot of Elias Darby Smith, nephew of Elizabeth's first city mayor, and Smith's niece, Mary Alward, the state's second woman lawyer and long-time secretary of the Union County Historical Society
44. The Brant monument has the name on both sides. A government marker for William Brant is on the roadside. He earned the Congressional Medal of Honor in the Civil War, served on the Elizabeth Police Department and was a volunteer fireman.
45. Walk along the road to the Rankin monument. In front of it is a footstone for James Alexander, Jr., an executive for the old Standard Oil Company of New Jersey.
46. Behind the Rankin lot is a monument for Captain Luther Martin, Company D, 11th Regiment, New Jersey Volunteers, who was killed at Gettysburg on July 2, 1863. He operated a newspaper in Plainfield before he joined the army.

47. The Sulzer monument contains names of four sons in the Roselle family. William Sulzer was impeached as governor of New York State. After he left office, it was discovered that he was innocent. His brother, Charles Sulzer, was a member of Congress from the territory of Alaska. The other two brothers, Lt. Thomas E. Sulzer (United States Army) and Captain Raymond Sulzer, United States Volunteers, died during the war against Spain in the Philippines.
48. Watch for the Dimock Family plot. The Dimocks once occupied the mansion that became Battin High School. Anthony Dimock wrote "How to Become a Millionaire by Twenty-One". He subsequently wrote boys books, worked as a stockbroker, a photographer and a naturalist.

The longer walk or ride takes the visitor into the Elizabeth and Newark sections of the cemetery. The walk or ride may take as long as three hours. The ride will take 15 minutes or longer depending upon the number of times stops are made.

49. Walk or drive along the road nearest Broad Street toward Lower Road, Elizabeth. Pause to look at the beautiful Italian statue for Helen Wagner on the left.
50. The "Singing Sam" Stevens monument is at the corner. The black marble monument with gold letters and illustration of the Gypsy musician is one of the largest and most elaborate in the cemetery. It is one of several along the perimeter of the cemetery or on tiny islands of land created by intersecting of several road ways. Gypsy graves also may be found in Park View 4 near Dayton Street.
51. Continue along the road that parallels Lower Road. Take the second left beyond the Civil War Veterans' Section. Observe the mausoleum built into the hillside for Sylvester Van Buskirk and James Jaques, erected in 1854. Like the Rankin mausoleum, it has an Egyptian motif above the door.
52. Turn right and at the next bend in the road (Section H) look for the Richards plot, a plain upright stone, for one of the first free African-American families in Elizabethtown. Continue along Section H to the road adjacent to Lower Road. The grave on the corner is for Dr. William A. Mack, who was the mayor who arranged the placement of the canon in the cemetery. He served the Elizabethport area, where the people loved him. A statue for him was placed on Elizabeth Avenue in the port facing the Arthur Kill.

53. Continue back to the road along B'nai Jeshurun Cemetery. Near the corner with Section K is the 400 year old White Oak Tree. The White Oak was selected in 1977 as the official tree of Union County.
54. Turn left at the tree. Go to Section Q. Drive along the Northern or left side. There is a low sandstone with the name Williamson. It is for Benjamin Williamson, whose father was a governor of New Jersey and his daughter-in-law, Emily, was a reformer.
55. A concrete wall surrounds the plot of John Brisbin, a Representative to Congress and president of the Delaware, Lackawanna and Western Railroad.
56. Seth Ryder, the only man to serve as both sheriff and mayor of Elizabeth is buried a short distance away.
57. Around the corner is a huge monolith for the defunct Third Presbyterian Church that once stood on Broad Street in Newark. In front of it are graves of Chinese Pilots in the American service who died in World War II.
58. A circular island of land between Sections Q and L is a plot for members of the Fraternal Order of Masons. Three lodges, now defunct, owned the plot.
59. Rev. Father Nestor Dmytriv who organized the First Ukrainian Catholic Church in Manitoba, Canada in 1897, is buried in Section J, opposite Section L, near the Masonic Section. Father Dmytriv served as editor of Svoboda. A woman conducted a drive for the black marble monument when she discovered that he didn't have a grave marker.
60. Section L is on a hillside. Graves moved from the Franklin Street Methodist Church Cemetery in Newark are at the top of the hill, while single graves are along the bottom.
61. Turn right at the next road between Park View 4 and Lawn Crest 1, 2 and 3. Lawn Crest Section 5 has a large number of Gypsies including five members of one family killed in a storefront fire in Brooklyn.
62. The English Tudor Chapel may be used for funeral services. The grave of C. Godfrey Poggi, an architect and designer of the chapel in 1932, is nearby in Park View 4.
63. Opposite the chapel is the grave of Luke or Lluka Myshuha (1887-1955), former editor of Svoboda, the largest Ukaranian language newspaper in the United States. His bust by Alexander Archipenko, an Ukrainian sculptor, has been stolen.
64. One of the prettiest monuments in the cemetery is in the next plot. It is for "Our Mary"

a young girl who struck and killed by a vehicle in St. Louis in 1950.

65. Beyond her are three monuments for members of the Lee Family. The last one contains the words, "King of the Lee Family". Among the Gypsies every man is a king and every woman is a queen. Another group of Gypsy monuments is at the curve in the road near Dayton Street and Weequahic Park Golf Course.

Follow the road back to North Broad Street. There are many other interesting stones in the cemetery, if you have time, park. Lock your car and walk around each one by one. One features a poem, another a bas relief of a man and his cat, another may be placed for somebody lost at sea or feature an anchor and cross. For most people the marker in the cemetery is the only indication that he or she has lived.

Written and Curated by Jean-Rae Turner

Booklet and Map Designed by Barbara A. Moss

Copyright ©1999 by Jean-Rae Turner & Barbara A. Moss

All Rights Reserved.